

21

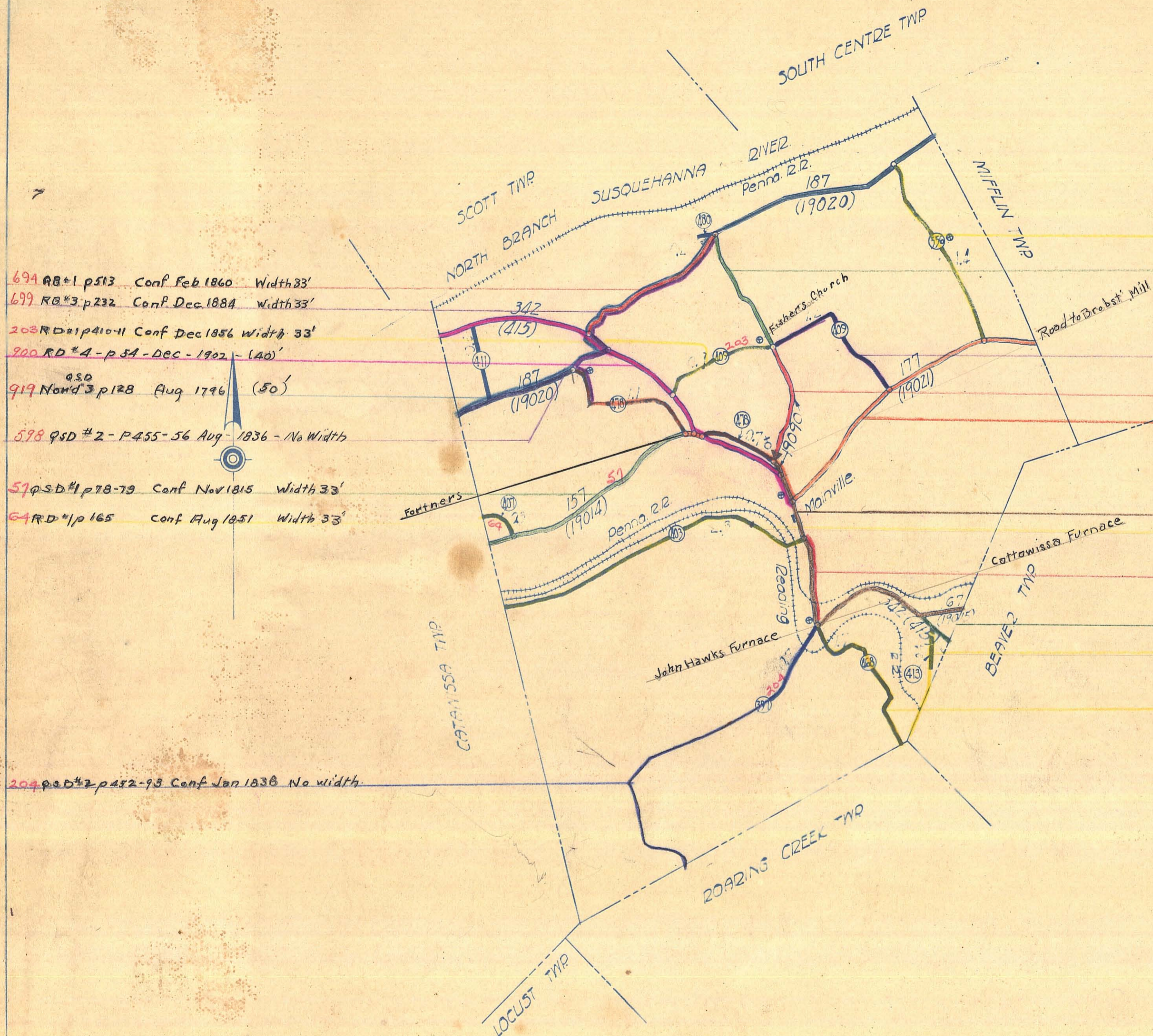

- 694 RB #1 p 513 Conf Feb 1860 Width 33'
- 699 RB #3 p 232 Conf Dec 1884 Width 33'
- 202 RD #1 p 410-11 Conf Dec 1856 Width 33'
- 900 RD #4 - p 34 - Dec - 1902 - (40)'
- 919 No. 3 p 128 Aug 1796 (50)
- 598 QSD #2 - P 455-56 Aug 1836 - No Width
- 57 QSD #1 p 78-79 Conf Nov 1815 Width 33'
- 64 RD #1 p 165 Conf Aug 1851 Width 33'
- 204 QSD #2 p 452-93 Conf Jan 1838 No width

- 36 RD #1 p 189 Conf Feb 1852 Width 33'
- RD #1 p 168 Conf Aug 1851 Width 33'
- 696 RB #3 p 396 Conf July 1891 Width 33'
- 698 RB #2 p 413 Conf May 1875 Width 33'
- 899 RD #4 - p 454 - Sept - 1910 - (33)
- 362 Northd Co QSD p 354 Conf Oct 1807 (33)'
- 202 Northd Co QSD 1802-10 Conf Jan 1809 (33)'
- 697 RB #2 p 434 Conf Sept 1875 Width 33'
- 693 RB #2 p 38-39 Conf Dec 1862 No Width
- 567 RD #3 - p 65 - Dec 1881 - (33)
- 695 RB #3 p 395 Conf Dec 1889 Width 33'
- 200 QSD #1 p 147-152 Conf Nov 1816 No width

LEGEND

- 157 (1902) State Highway System
- 187 (1902) Township Road System
- County Roads
- Church
- School
- TYPE
- White Unimproved
- Yellow Stone Road
- Green Bituminous Macadam
- Red Concrete, Brick

TOTAL MILES	
Township Road System	11.5
State Highway System	14.9
Total	26.4

THIS WORK PERFORMED UNDER W.P.A.
 PROJECTS SW-254 and SW-103,
 SEARCHING RIGHT-OF-WAY RECORDS
 BY EMPLOYEES OF THE W.P.A.

TOWNSHIP ROAD MAP
 MAIN TOWNSHIP
 COLUMBIA COUNTY
 County Code No. 19

SCALE
 0 3000 6000 9000

One Inch = Approx. 3000 ft.
 (Original)